

ALU SERIES-ALU 1-0536

EAN 8422202105369



Our range of ALU design castors with polyurethane nickel aluminium wheel, does not scratch the floor. Smooth tread.

It is used in: interior furniture, tables, auxiliary furniture, display stands, decoration, stackable boxes, display cabinets, stools, do-it-yourself shops, beauty and hairdresser's equipment, commercial spaces, interior design, fashion shops, design furniture and home.

Technical Data

Housing Type	Swivel
Fitting Type	Plate
Braking System	Without Brake
Material	Aluminium-Design
Bearing	Plain
Diameter (mm)	75
Width of tyre (mm)	24
Plate dimensions (mm)	60x60
Distance between holes (mm)	45x45
Plate hole diameter (mm)	6
Overall height (mm)	98
Load	45
Unit Weight of the wheel (kg)	0.45
Volume (cm ³)	529

CAD

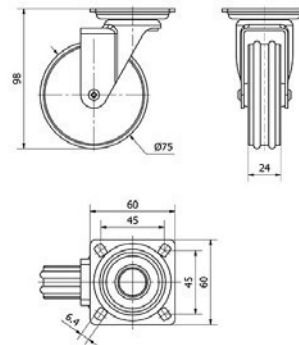

To visualize the image with higher resolution and more technical details, please access to the CAD section

Brackets

Material: Pressed steel.Finish: nickel-plated.Fitting Type: Swivel plate. Double polyurethane-tyred on nickel-plated centre (stainless steel effect). Available with break.

Similar products



1-0539